

# Invia® Liberty™

The Invia Liberty NPWT System with FitPad provides Intelligent Pressure Control with Dynamic Exudate Removal to help ensure NPWT is reliably delivered and controlled at the wound site.

Invia Liberty is designed for ease of use with eight preset pressure settings and a default setting of -125mmHg. Click in canister attachment and one-touch canister release button allow for easy canister exchange. Intuitive and quiet pump operation promotes full integration during the patient's daily life. Patient comfort and mobility are facilitated by Invia Liberty's compact, lightweight design and convenient carrying case.



## Invia Liberty

- Intelligent Pressure Control from the pump to the wound site
- Dynamic Exudate Removal helps prevent blockages from the wound to the pump
- Pressure options from -40 to -200 mmHg including standard -125mmHg
- On-screen air leak indicator
- New customer air leak modes for normal and large wounds
- Easy and secure tubing attachment with the Quick-connector
- One-touch canister release button
- Choice of 300ml and 800ml disposable canisters with solidifier

Item #	Description	Units	HCPCS	MSRP
0871000	<b>Invia Liberty NPWT device</b>	1	0	\$12995.00
08700	<b>Invia Liberty System rental includes:</b> Hard shipping case Carrying bag Power adapter Instructions for use for clinician and patient.	1	E2402	N/A

## Invia Liberty

Item #	Description	Case Qty	HCPCS	MSRP
0870012	<b>300ml canister with solidifier</b> Not autoclavable. Item/device is a single use item. Do not reuse the item. Item is not made with natural rubber latex and is sterilized using ethylene oxide (EO).	10	A7000	\$325.00
0870017	<b>800ml canister with solidifier</b>	6	A7000	\$225.00
3007339	<b>Carrying case</b>	10	N/A	\$250.00
0770148	<b>Power supply</b>	1	N/A	\$135.00
0870025	<b>Liberty tubing with Quick-connector</b>	10	N/A	\$250.00

### Technical specifications

Max. vacuum . . . -27kPa, -200mmHg  
 Min. vacuum . . . -8kPa, -40mmHg  
 Power . . . . . In: 100-240 VAC, 0.8-0.4A, 50-60 Hz  
 . . . . . Out: 12 VDC, 2.5A, 30W  
 Dimensions . . . . 6.69" x 5.91" x 3.74"  
 Weight . . . . . 2.2lbs, 1.0kg  
 Battery life . . . . ≤ 10 hours  
 Therapy mode . . Constant and Intermittent  
 Languages . . . . Multiple

\*Invia Liberty rental equipment must be returned prior to the first of each month. A minimum of 30 days will be invoiced on all initial rentals.

\*Minimum 5 pump purchase order.

\*25+ units must be purchased at one time to obtain quantity discount pricing. Active contract required to purchase Medela Negative Pressure Wound Therapy products.

Consult the indications, precautions and contraindications contained within the Invia Liberty instructions for use.

# Invia® Motion™ – 60 Days

The Invia Motion – 60 Days NPWT System with FitPad provides Intelligent Pressure Control with Dynamic Exudate Removal to help ensure NPWT is reliably delivered and controlled at the wound site.

The Invia Motion – 60 Days delivers the convenience of a personal, single-patient-use pump while offering clinical flexibility with a choice of pressure settings, therapy modes and compatibility with both foam and gauze dressings. The Invia Motion - 60 Days is appropriate for use when 60 days life use is needed. The compact design and quiet operation helps patients to comfortably go about daily activities for the duration of therapy.



## Invia Motion – 60 Days

- Intelligent Pressure Control from the pump to the wound site
- Dynamic Exudate Removal helps prevent blockages from the wound to the pump
- Every patient obtains a new, clean pump
- 60 Days run time
- Audible and visual notifications and troubleshooting
- Small and lightweight design
- Suction capacity 1 liter/min
- Constant and intermittent therapy modes
- Multiple pressure settings; preset - 125mmHg
- Compatible with foam and gauze dressing kits

Item #	Description	Case Qty	HCPCS	MSRP
0874014	<b>Invia Motion – 60 Days</b> NPWT device, carrying case, power supply, and clinician and patient instructions for use.	1	N/A	\$1500.00
0874016	<b>Invia Motion canister/tubing set 150ml, with solidifier and Quick-connector</b> Not autoclavable. Item/device is a single use item. Do not reuse the item. Item is not made with natural rubber latex and is sterilized using ethylene oxide (EO).	5	A7000	\$175.00
0874003	<b>Carrying case</b>	10	N/A	\$250.00
2009475	<b>Power supply</b>	1	N/A	\$65.00
0874004SB	<b>Invia Motion return box</b>	1	N/A	\$15.00

### Technical specifications

Max. vacuum . . . . .	-175mmHg	Dimensions . . . . .	3.9" x 3.86" x 2.05"
Min. vacuum . . . . .	-40mmHg	Weight . . . . .	0.88 lbs
Power . . . . .	In: 100-240VAC, 0.4A, 50-60 Hz	Battery life . . . . .	>10 hours
	Out: 9VDC, 0.9A, 8W	Therapy mode . . . . .	Constant and Intermittent
Power supply cable . . . . .	67.71"/5' 6"	Languages . . . . .	English

Active contract required to purchase Medela Negative Pressure Wound Therapy products.  
Consult the indications, precautions and contraindications contained within the Invia Motion instructions for use.

# Invia® NPWT Dressings

For use with Invia Liberty & Invia Motion NPWT Systems.

## Invia Foam Dressing Kits

### Small Dressing Kit

- 1 Foam (10 x 8 x 3cm)
- 1 Transparent Film (26 x 32cm)
- Invia FitPad - suction interface with double lumen

### Medium Dressing Kit

- 1 Foam (19 x 12.5 x 3cm)
- 2 Transparent Film (26 x 32cm)
- Invia FitPad - suction interface with double lumen

### Large Dressing Kit

- 1 Foam (25 x 15 x 3cm)
- 2 Transparent Film (26 x 32cm)
- Invia FitPad - suction interface with double lumen

### Extra Large Dressing Kit

- 1 Foam (60 x 30 x 1.5cm)
- 5 Transparent Film (26cm x 32cm)
- Invia FitPad - suction interface with double lumen

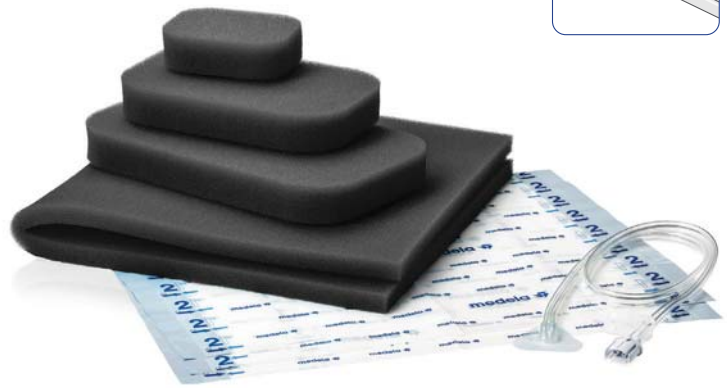

Double lumen to the wound

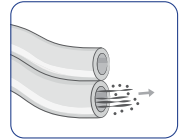

Invia FitPad

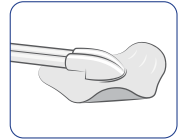

Quick-connector

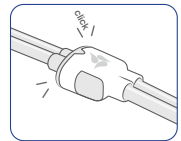

## Ordering Information - Invia Foam Dressing Kits with FitPad

Items/devices are a single use item. Do not reuse the item. Item is not made with natural rubber latex and is sterilized using ethylene oxide (EO).

Item #	Description	Case Qty.	HCPCS Code	MSRP
0876221 0876225	<b>Invia Foam Dressing Kit with FitPad, Small</b>	3 15	A6550	\$142.00 \$660.00
0876222 0876226	<b>Invia Foam Dressing Kit with FitPad, Medium</b>	3 15	A6550	\$165.00 \$705.00
0876223 0876227	<b>Invia Foam Dressing Kit with FitPad, Large</b>	3 15	A6550	\$168.00 \$765.00
0876224	<b>Invia Foam Dressing Kit with FitPad, X-Large</b>	3	A6550	\$255.00
0870024	<b>Drain adapter with Quick-connector</b>	10	N/A	\$140.00
0870028	<b>Invia FitPad</b> • suction interface with double lumen	10	N/A	\$115.00
0870030	<b>Invia Transparent Film</b>	20	N/A	\$220.00

## Invia Silverlon



## Invia Silverlon NPWT Antimicrobial Wound Contact Dressings

Item #	Description	Case Qty.	HCPCS Code	MSRP
0877001	<b>4" x 5" Invia Silverlon NPWT Antimicrobial Wound Contact Dressing</b>	10	N/A	\$250.00
0877002	<b>5" x 8" Invia Silverlon NPWT Antimicrobial Wound Contact Dressing</b>	10	N/A	\$450.00

# Invia Gauze Dressing Kits

Invia Gauze Dressing Kits consist of a roll or pad Antimicrobial Gauze, a FitPad or internal drain, and Transparent Film. Kits are conveniently packaged with individualized sterilized supplies needed for a dressing change including: barrier film wipes, saline bullets, strip paste, and non-sterile adhesive tape. Kits with a FitPad do not include strip paste and adhesive tape.

## Drain Characteristics



**Invia FitPad**

- The low profile design and flexible wings of the suction interface (Invia FitPad) allow appropriate placement in difficult anatomic locations.
- Double lumen suction interface



**15Fr Round Channel Drain**

- Multipurpose applications
- Designed to efficiently channel drainage
- Channels help prevent clotting or occlusions
- Minimizes tissue in-growth
- Radiopaque silicone allows for X-ray detection

## Ordering Information - Invia Gauze Dressing Kits

Items/devices listed below are single use devices. Do not reuse the device. Devices listed below are not made with natural rubber latex.

Order Number	Description	Case Quantity	HCPCS Code	MSRP
0877170 0877172	<b>Invia Gauze Dressing Kit with FitPad, Medium</b> 1 – Kerlix™ AMD™ Antimicrobial Gauze (6" x 6.75") 1 – Invia Transparent Film 1 – Sterile Saline 30ml	3 15	A6550	\$151.00 \$690.00
0877171	<b>Invia Gauze Dressing Kit with FitPad, Large</b> 1 – Kerlix AMD Antimicrobial Roll Gauze 1 – Invia Transparent Film 1 – FitPad 2 – Sterile Saline 30ml	3	A6550	\$180.00
0877064 0877063	<b>Invia Gauze Dressing with 15Fr Channel Drain, Medium</b> 1 – Kerlix AMD Antimicrobial Gauze (6" x 6.75") 1 – Invia Transparent Film 1 – 3M Cavilon barrier film wipes 1 – Channel Drain 1 – Sterile Saline 30ml	3 15	A6550	\$190.00 \$690.00
0870028	<b>Invia FitPad</b>	10	N/A	\$115.00
0870024	<b>Drain Adapter</b> • with Quick-connector	10	N/A	\$140.00
0870030	<b>Invia Transparent Film</b>	20	N/A	\$220.00

# Invia® Liberty canister

## Disposable canisters with solidifier

Disposable polycarbonate canisters include solidifier, sealing cap, and overflow bacteria filter. Disposable canisters are not autoclavable.



Items/devices listed below are single use devices. Do not reuse the device. Devices listed below are not made with natural rubber latex and they are sterilized using ethylene oxide (EO).

Item #	Description	Case Qty.	HCPCS Code	MSRP
0870012	<b>300ml Invia Liberty canister</b>	10	A7000	\$325.00



Item #	Description	Case Qty.	HCPCS Code	MSRP
0870017	<b>800ml Invia Liberty canister</b>	6	A7000	\$225.00

# Invia® Liberty tubing

The tubing is comprised of two lumens: The smaller lumen (control lumen) regulates the pressure and the larger lumen (removal lumen) removes the fluid from the wound into the canister. A hydrophilic overflow protection/bacteria filter in the tubing base helps to prevent contamination of Invia Liberty pump.



Item/device is a single use item. Do not reuse the item. Item is not made with natural rubber latex and is sterilized using ethylene oxide (EO).

Item #	Description	Case Qty.	MSRP
0870025	<b>Invia Liberty tubing with Quick-connector</b>	10	\$250.00

# Invia® Liberty accessories

## Docking station

Used in conjunction with the Invia Liberty pump, the docking station provides a stable surface and continuous charge of the Invia device.

Item is not made with natural rubber latex.



Item #	Description	Case Qty.	MSRP
0790037	<b>Docking station - coaxial</b>	1	\$275.00

## Port cover

Port covers used for the Liberty/Thopaz are purchased in 10 packs.



Item #	Description	Case Qty.	MSRP
0770124	<b>Port cover - Liberty/Thopaz</b>	10	\$65.00

## Carrying case

Convenient, lightweight carrying bag for easy transfer of the Invia Liberty pump/system.



Item #	Description	Case Qty.	MSRP
3007296	<b>Carrying case</b>	1	\$21.00
3007339	<b>Carrying case (case of 10)</b>	10	\$200.00

Pump & tubing not included.

## Shipping hard case

Hard case container for Invia Liberty pump/system protects from damage during shipping.



Item #	Description	Case Qty.	MSRP
8107179	<b>Shipping case</b>	1	\$160.00

## Power supply

AC/DC electrical plug for charging Invia Liberty pump.



Item #	Description	Case Qty.	MSRP
0770148	<b>Power supply - coaxial</b>	1	\$135.00

\*Note: Please review device and/or docking station power adapter insertion site to select appropriate plug.

## USB cable

Item #	Description	Case Qty.	MSRP
9287012	<b>USB cable - retractable</b>	1	\$20.00



## Universal rail holder

The universal rail holder can be used to affix the Invia Liberty pump to any weight-bearing surface. Rail is 11.5" x 1" x .375".



Item #	Description	Case Qty.	MSRP
5207013	<b>Universal rail holder</b>	1	\$100.00

## Sealing ring

Silicone ring to ensure a proper seal between canister and pump.

Device listed below are not made with natural rubber latex.



Item #	Description	Case Qty.	MSRP
0990343	<b>Vacuum port seal ring</b>	10	\$50.00

# NPWT System dressing accessories

For use with Invia Liberty and Invia Motion NPWT Systems.

## Invia® Transparent Film



Waterproof film is designed to protect the integrity of the wound. It is easy to cut to fit each unique wound size. Transparent dressing should reach 3cm beyond wound bed. White adhesive tape provides strong adhesion while gentle to the skin. Item listed below are not made with natural rubber latex.

Item #	Description	Case Qty.	MSRP
0870030	<b>Invia Transparent Film</b>	20	\$220.00

## FitPad

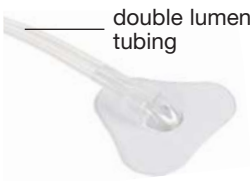

double lumen tubing

The low profile design and flexible wings of the suction interface (Invia FitPad) allow appropriate placement in difficult anatomic locations. Allows for negative pressure delivery and control at the wound site.

Item #	Description	Case Qty.	MSRP
0870028	<b>FitPad</b>	10	\$115.00

## 15Fr Channel drain

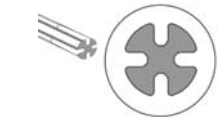

Item #	Description	Case Qty.	MSRP
0870032	<b>15Fr Channel drain</b>	10	\$300.00

## ESI External Suction Interface



Item/device are a single use item. Do not reuse the item. Item is not made with natural rubber latex.

Item #	Description	Case Qty.	MSRP
0780025	<b>ESI</b> External Suction Interface, Transfer Pad	20	\$230.00

## Drain adapter



Item/device are a single use item. Do not reuse the item. Item is not made with natural rubber latex.

Item #	Description	Case Qty.	MSRP
0870024	<b>Drain adapter</b> For adapting Quick-connector tubing (#0870025 Liberty tubing with QC) to single lumen drains (examples #0780025 ESI and Gauze kits with 15Fr Channel drain)	10	\$140.00

## Y-connector



The Y-connector allows treatment of multiple wound sites on the same patient with only one NPWT device.

Item/device is a single use item. Do not reuse the item. Items is not made with natural rubber latex and is sterilized using ethylene oxide (EO).

Item #	Description	Case Qty.	MSRP
0870023	<b>Y-connector with Quick-connector</b>	10	\$200.00



# Limited warranty

## Invia Liberty and Invia Motion

The Invia Liberty and Invia Motion Negative Pressure Wound Therapy Systems are warranted by Medela, Inc. to the original purchaser to be free from defects in material and workmanship for a period of two (2) years from the date of purchase.

THE LIABILITY OF MEDELA FOR BREACH OF ANY WRITTEN OR IMPLIED WARRANTY IS LIMITED TO REPAIR OR REPLACEMENT OF THIS PRODUCT, AND MEDELA WILL HAVE NO LIABILITY UNDER ANY CIRCUMSTANCES FOR ANY INCIDENTAL OR CONSEQUENTIAL DAMAGES. SOME STATES DO NOT ALLOW THE EXCLUSION OR LIMITATION OF INCIDENTAL OR CONSEQUENTIAL DAMAGES, SO THE ABOVE LIMITATIONS OR EXCLUSIONS MAY NOT APPLY TO YOU.

THIS WARRANTY GIVES YOU SPECIFIC LEGAL RIGHTS AND YOU MAY ALSO HAVE OTHER RIGHTS, WHICH VARY FROM STATE TO STATE.

If you wish to make a claim under this warranty, you must first obtain a Return Merchandise Authorization (RMA) number from Medela, then return your product with a brief statement of the problem to the following address:

Medela LLC  
Attn: Returns Department, Door 4501  
1101 Corporate Drive  
McHenry, IL 60050

To obtain information concerning this warranty, call toll-free 1-877-MY INVIA (1-877-694-6842).



**Please contact us or your local Medela representative for details.**

**CAUTION: U.S. Federal law restricts this device to sale by or on the order of a physician.**

Medela, Invia, and Invia FitPad are registered with the US Patent and Trademark Office. Liberty is a trademark of Medela.

AMD and Kerlix are trademarks of Covidien. 3M, Cavilon No Sting, Tegaderm Film and Tegaderm Non-Adherent Contact Layer are trademarks of 3M Healthcare. Hy•Tape is a registered trademark of Hy•Tape International. Coloplast is a registered trademark of Coloplast A/S.

 Medela AG  
Lättichstrasse 4b  
6341 Baar / Switzerland  
[www.medela.com](http://www.medela.com)

Medela LLC  
1101 Corporate Drive  
McHenry, IL 60050  
USA  
Phone +1 877 735 1626  
Fax +1 815 307 8942  
[info-healthcare@medela.com](mailto:info-healthcare@medela.com)  
[www.medela-healthcare.us](http://www.medela-healthcare.us)

**Local contact:**